

1. Go to Galenalodge.com
2. Under the summer drop down tab at the top select “Kids Camp”

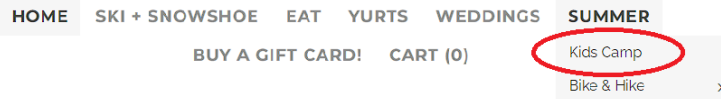

3. Scroll down to see the Register/ Membership camp box (This may take a few seconds to load)
4. Select “Register”

Greetings Campers and Parents!

General registration for the Galena Youth Adventure Camp will open promptly at 6:00 pm MST on February 1st 2023 (If your child attends school in Blaine County, please sign up for the local membership below). Once again the demand for camp increased last year and we are ready and determined to continue improving the user experience. One noteworthy improvement is that after you add an item to your cart you will have 30 minutes to complete the transaction, thereby eliminating the race to type quickly.

[Click here for registration help!](#)

Register Memberships

Memberships

Search

Local Student Membership (Must attend school in Blaine Co.) **\$0.00**

Individual membership

Application due 1/25/23 at 5 pm. Your child(ren) must attend school in Blaine Co. Allows you to sign up 1 day early for one week of camp and provides a 20% discount.

[Add to cart](#)

5. Click the "Practice Registration" button

eliminating the race to type quickly.

[Click here for registration help!](#)

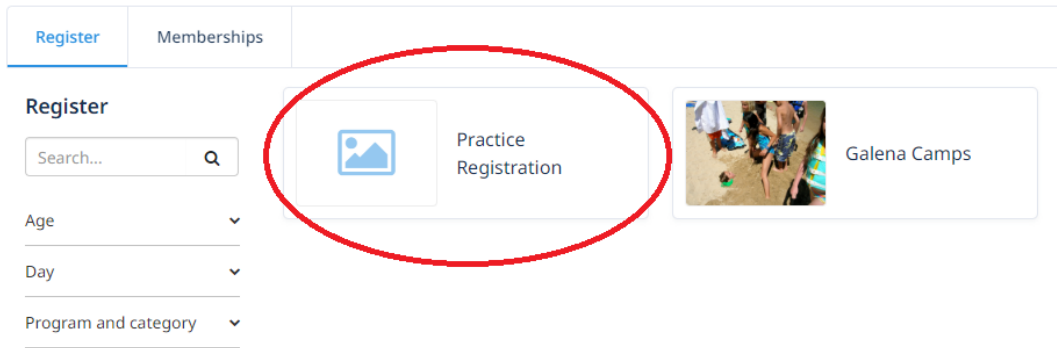

The screenshot shows a web interface with two tabs: "Register" (active) and "Memberships". Below the tabs is a "Register" section containing a search bar with a magnifying glass icon, and three dropdown menus labeled "Age", "Day", and "Program and category". To the right of the search bar is a button with a picture icon and the text "Practice Registration", which is circled in red. Further right is another button with a photo of people and the text "Galena Camps".

Powered by Amilia

6. Click the "Practice" dropdown.

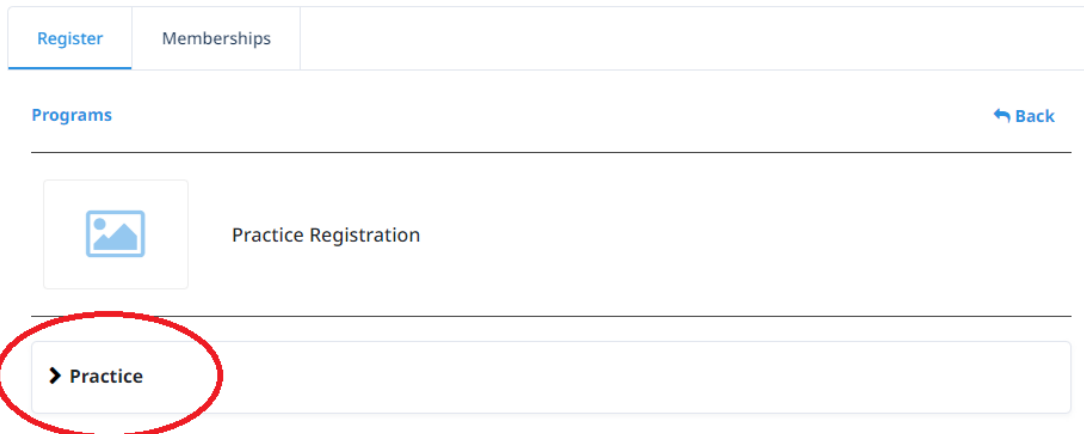

The screenshot shows a web interface with two tabs: "Register" (active) and "Memberships". Below the tabs is a "Programs" section with a "Back" button. The main content area contains a button with a picture icon and the text "Practice Registration". Below this is a dropdown menu with a right-pointing arrow and the text "Practice", which is circled in red.

Powered by Amilia

7. Click the “practice” with the plus sign next to it

Register | Memberships

Programs [Back](#)

 Practice Registration

▼ Practice

 Practice

Powered by Amilia

8. Click on the blue add person button underneath the word “session”

Register | Memberships

Programs [Back](#)

 Practice Registration

▼ Practice

Practice

Practice Registration

This is a practice registration to eliminate any issues when registration day arrives

[More information ...](#)

Schedule: From Friday, January 13, 2023 at 5:17 PM until Saturday, August 5, 2023 at 5:17 PM

Start date: 1/13/2023

Session

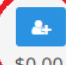
 \$0.00

9. Select "create an account" if you have never logged in before (this account is for the adult not the child), If you already created an account use your login information to log in

improvement is that after you add an item to your cart you will have 30 minutes to complete the transaction, thereby eliminating the race to type quickly.

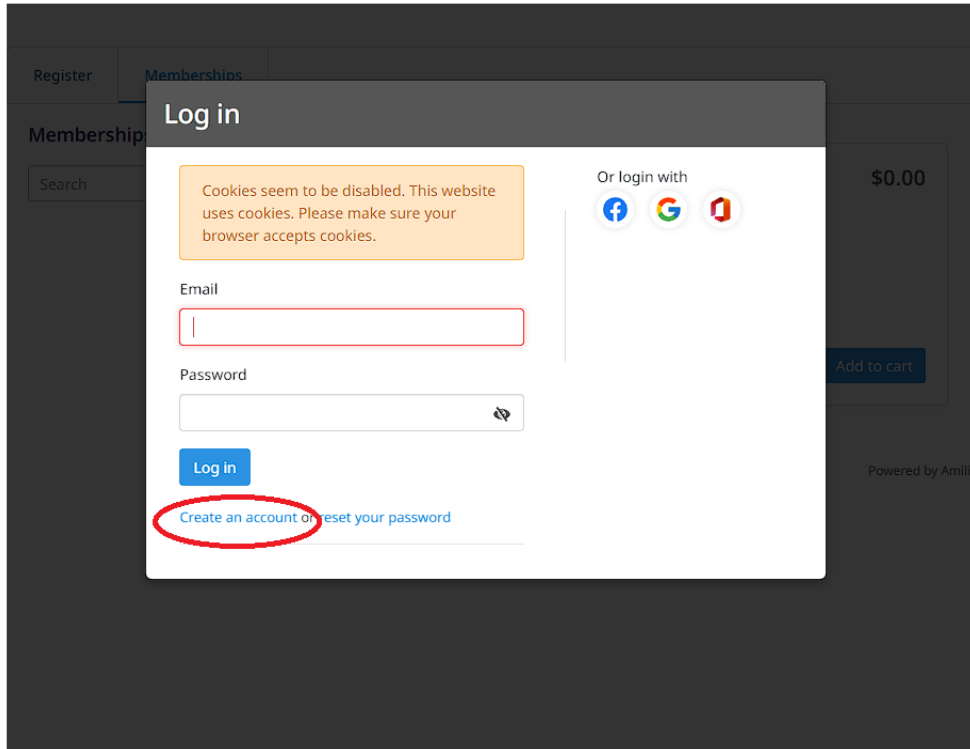

10. Fill out the information and click verify email



increased last year and we are ready and determined to continue improving the user experience. One noteworthy improvement is that after you add an item to your cart you will have 30 minutes to complete the transaction, thereby eliminating the race to type quickly.

Register Memberships

Membership Search

Create an account

Cookies seem to be disabled. This website uses cookies. Please make sure your browser accepts cookies.

Or login with   

First Name

Last Name

Email

Password

Verify email

By clicking on "Verify email", you agree to the [User Service Agreement](#) and [Privacy Policy](#).

\$0.00

Add to cart

Powered by Amilia

11. You will be emailed a verification code right away.



Welcome to Amilia, Info Info!

Thank you for registering at Amilia SmartRec.

To get started, we need to verify your email address.

To activate your account, please enter the code below in our website:

925043

This code will expire in 10 minutes.

Amilia Enterprises Inc. • 1-877-343-0004
1751 Richardson Street, Suite 3.105 • Montreal, QC • H3K 1G8 Canada

12. Input the verification code

improvement is that after you add an item to your cart you will have 30 minutes to complete the transaction, thereby eliminating the race to type quickly.

Register Memberships

Membership Search

\$0.00

Add to cart

Powered by Amilia

Create an account

Verify email address

Check your email for the verification code sent to Info@galenalodge.com [\(Change\)](#)

9 2 5 0 4 3

Didn't get it? [Resend](#)

[Verify](#)

Can't find your code? Check your spam folder

Galena Youth Adventure Camp (8-12)
Monday-Friday 9am to 4pm (Thursday
night overnight)

Galena Mountain Bike Camp (8-12)
Monday-Friday 9:30am to 3:30pm

Galena Kids Adventure Camp (6-8)
Monday-Friday 9am to 3pm

Galena Mountain Bike Camp is

This camp is designed for our younger

13. Click continue

14. Check the I consent box and click continue

15. This is where you add your child to your account. You may need to scroll down to find the add a person button. Click "Add Another Person"

improvement is that after you add an item to your cart you will have 30 minutes to complete the transaction, thereby eliminating the race to type quickly.

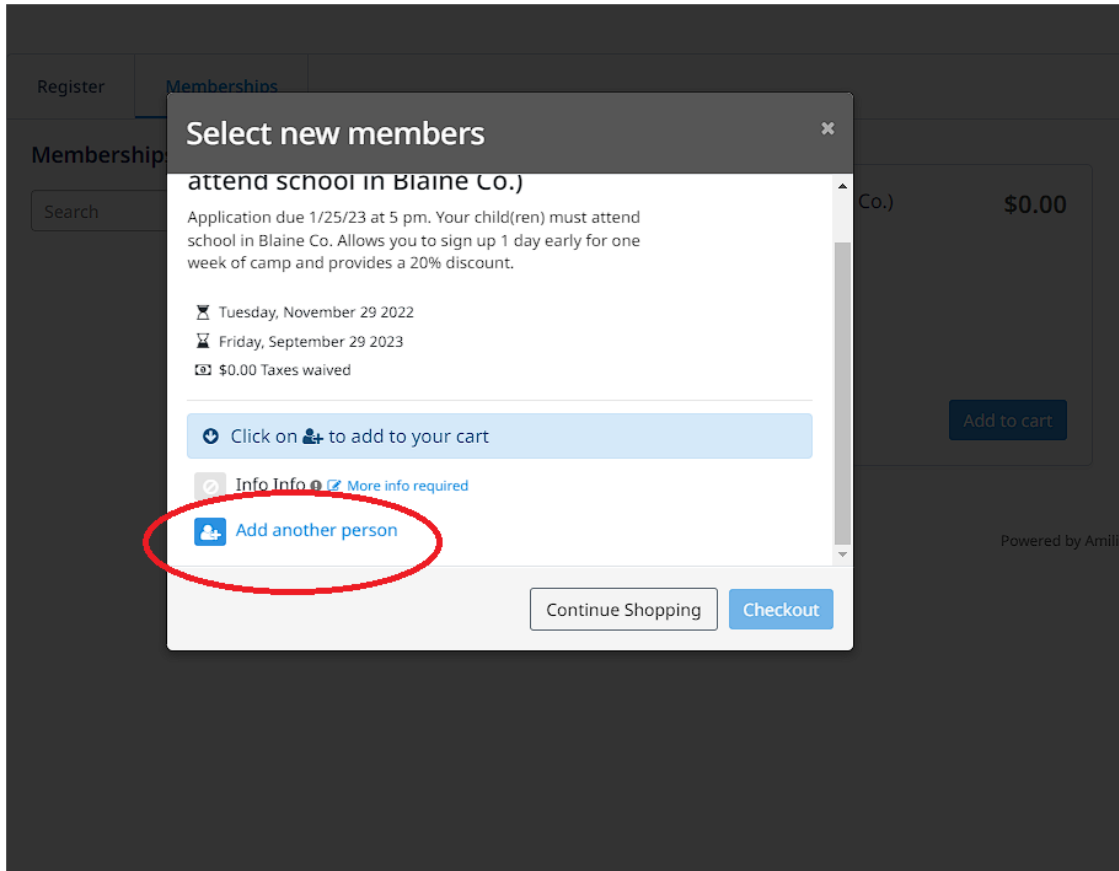

Galena Youth Adventure Camp (8-12)
Monday-Friday 9am to 4pm (Thursday
night overnight)

Galena Mountain Bike Camp (8-12)
Monday-Friday 9:30am to 3:30pm

Galena Kids Adventure Camp (6-8)
Monday-Friday 9am to 3pm

16. Fill out the information and be sure to select "Child". Click "continue"

17. If you need to add another child go back to step 11

18. Select all participants you want to add by clicking on the blue button next to the participants name

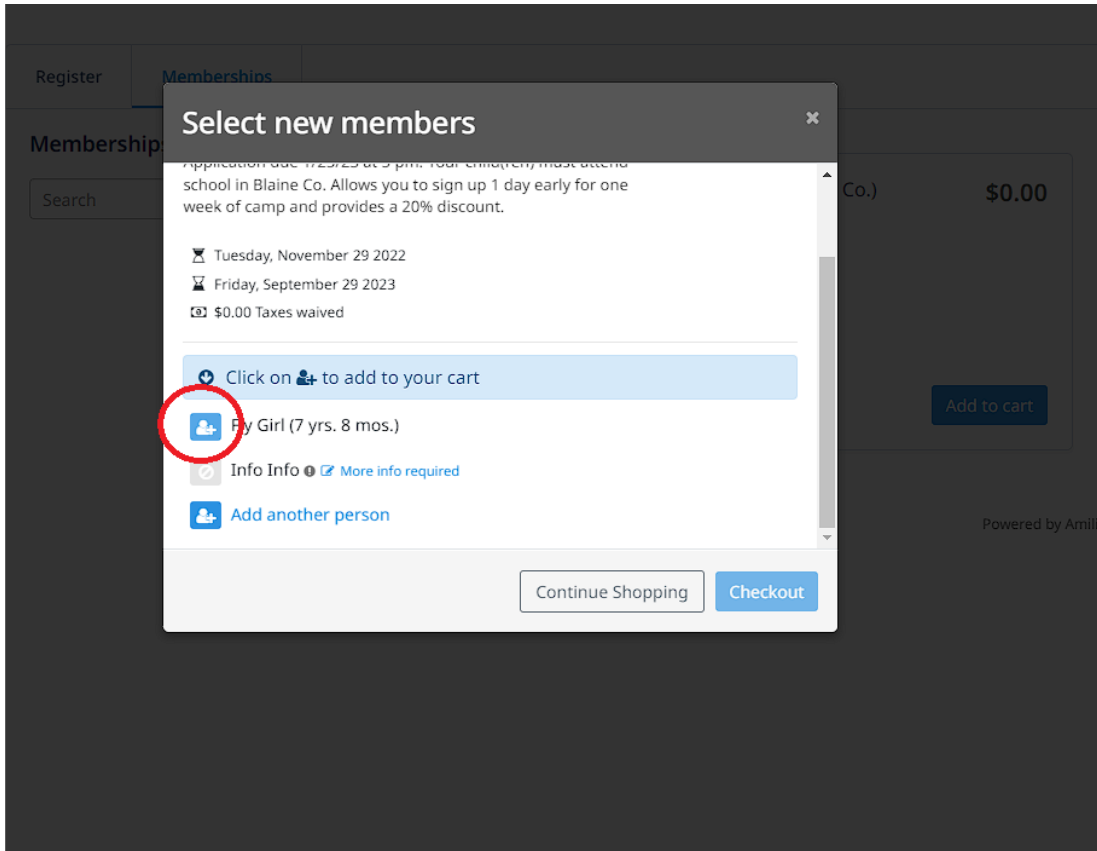

Galena Youth Adventure Camp (8-12)
Monday-Friday 9am to 4pm (Thursday
night overnight)

Galena Mountain Bike Camp (8-12)
Monday-Friday 9:30am to 3:30pm

Galena Kids Adventure Camp (6-8)
Monday-Friday 9am to 3pm

19. Select checkout and continue through the checkout process. Fill out the forms with accurate information as some of this will autofill during the real registration.